

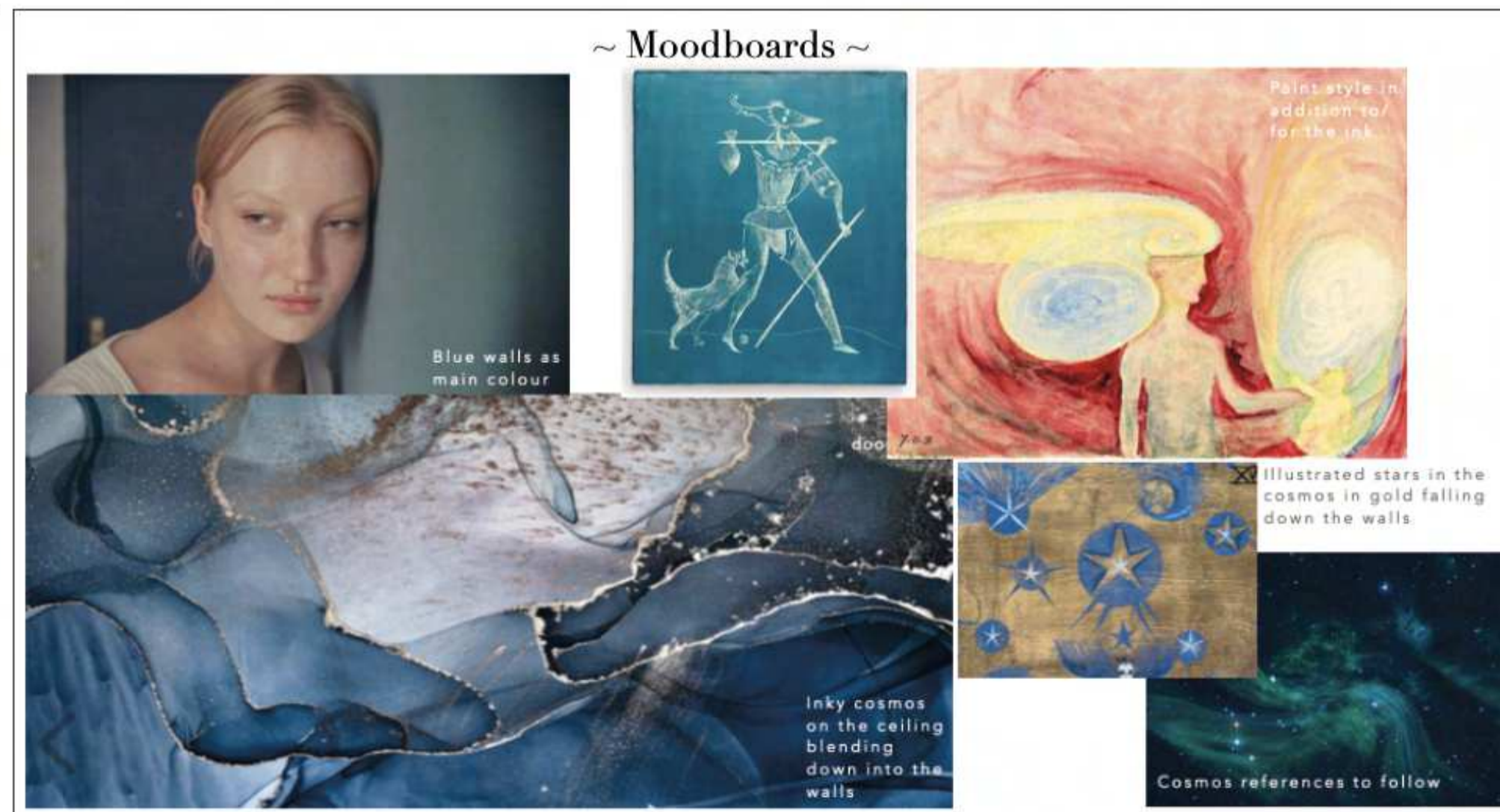

~ COSMOS MURAL ILLUSTRATION ~



~ Sketchup Render ~



~ Moodboards ~



~ Mural Palette ~

~ Base Paint Colour ~

"TUESDAY"		Drama O. Psude	
INT. HOUSE		Laura Ellis Cricks	
SET	INT. HOUSE	SET CLERK	BRANDON AN
DETAILS			
COSMOS MURAL			
STAGE 3			
SCENE	STAGE 3	SCALE	N/A
LOCATION		PAGE SIZE	A2
DRAWN BY	JOSHUA BROOKS	DATE ISSUED	NOT ISSUED
REVISION DATE		SCALE	N/A
PAGE SIZE			
SUPERVISING ART DIRECTOR	REVISIONAL	COVERED BY	
DIRECTOR	ART DIRECTOR	PAINTER	WALLPAPER
DESIGNER	SET DESIGNER	CARPENTER	YES
GLAZIER		PLASTERER	YES
PAINTER		PAINTER	REEL NUMBER
PROP MASTER		PROP MASTER	SCENE NUMBER
PRODUCTION	SHIPPED	STATUS	

Lake

THE 1975 - MONDAY // 4 QUARTER SET FLOOR PLANS AND ELEVATIONS

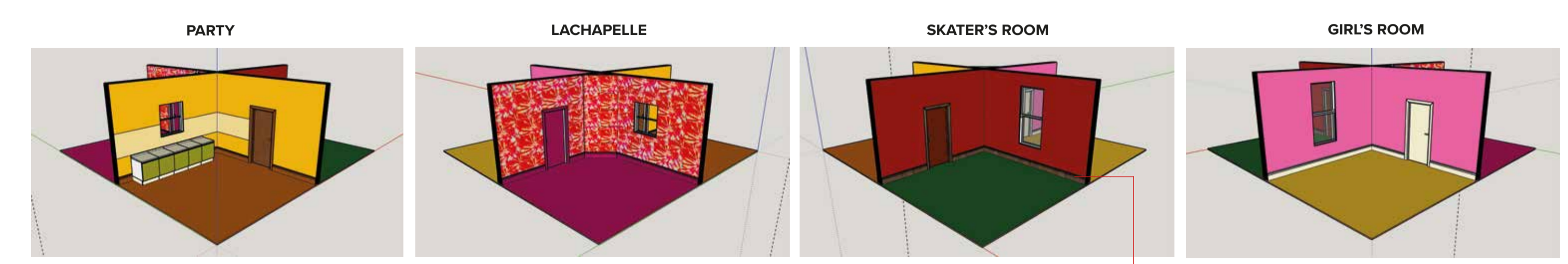
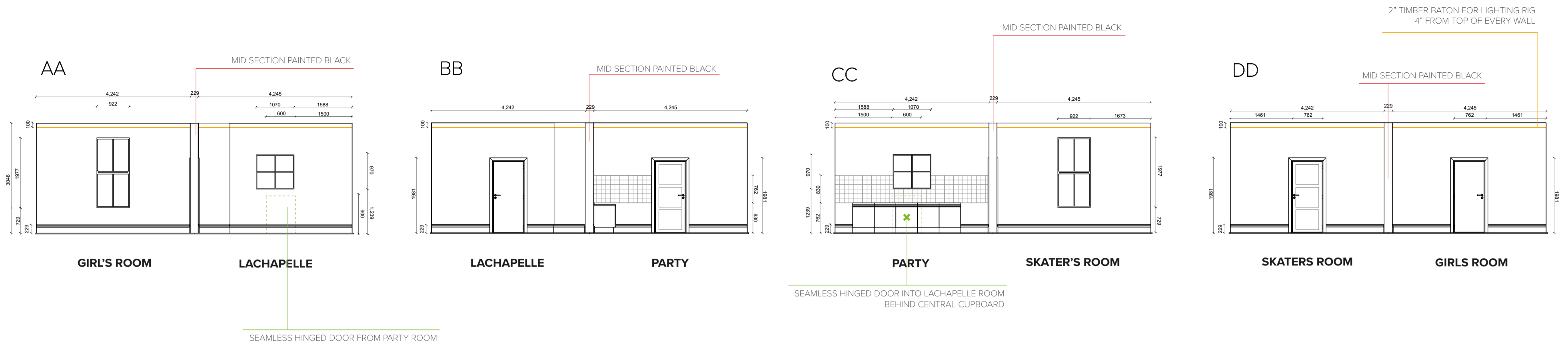

PARTY
 YELLOW PAINTED WALLS DULUX 25YY 50/592
 SKIRTING AND ARCHITRAVE COLOUR - DULUX 06 D 45
 TANNED CREAM PAINTED WALL TILING - DULUX 38YY 81/256
 DIRTY DOWN SURAFCES AND TILING

L'CHAPELLE
 PURPLE PAINTED DOOR, SKIRTING AND ARCHITRAVE
 DULUX 76RR 08/316

SKATER'S ROOM
 RED PAINTED WALLS - DULUX 04YR 11/537
 DARK WOOD STAIN SKIRTING AND ARCHITRAVE
 DIRTY DOWN SURAFCES

GIRL'S ROOM
 PINK PAINTED WALLS - DULUX 47RR 32/383
 WHITE PAINTED DOOR, SKIRTING AND ARCHITRAVE - DULUX 30GY 88/014
 DIRTY DOWN SURAFCES

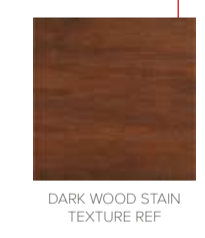

KEY	PAINTERS NOTES

CONSTRUCTION NOTES	
PARTY	PLASTIC WALL TILES PROVIDED BY CONSTRUCTION PRIMED MDF SKIRTING WICKES TORIS [Product Code: 162764] ARCHITRAVE JAMES MANFIELD M40
L'CHAPELLE	BLOOD RED CARPET FLOORING DC PATTERNED ADHESIVE WALLPAPER PRIMED MDF SKIRTING WICKES CHAMFERED [Product Code: 133234] ARCHITRAVE JAMES MANFIELD M40 SEAMLESS HINGED DOOR TO PARTY ROOM
SKATERS ROOM	FOREST GREEN CARPET FLOORING PRIMED MDF SKIRTING WICKES TORIS [Product Code: 162764] ARCHITRAVE JAMES MANFIELD M40
GIRLS ROOM	MUSTARD YELLOW CARPET FLOORING PRIMED MDF SKIRTING FOR GIRL'S ROOM WICKES CHAMFERED [Product Code: 133234] ARCHITRAVE JAMES MANFIELD M40 WINDOW TO OPEN UPWARDS
360 CAMERA TRACK TO COMPLETELY SURROUND SET WALL TOPS AND ENDS TO BE FACED WITH 5mm PLY HIDING SEAMS ALL DOOR FURNITURE PROVIDED BY SET DEC CARPET TO BE LAID AFTER CONSTRUCTION	

PAINTERS NOTES	
MAINTAIN ORIGINAL PAINT COLOUR FOR ALL WINDOW FRAMES AGEING ADDED TO ALL WINDOWS	
PARTY YELLOW PAINTED DULUX 25YY 50/592 WALLS SATIN FINISH ON ALL WALL FACES SKIRTING AND ARCHITRAVE COLOUR - DULUX 06 D 45 TANNED CREAM PAINTED WALL TILING - DULUX 38YY 81/256 DIRTY DOWN SURAFCES AND TILING	
L'CHAPELLE PURPLE PAINTED DOOR, SKIRTING AND ARCHITRAVE DULUX 73RB 08/259	
SKATERS ROOM RED PAINTED WALLS - DULUX 04YR 11/537 DARK WOOD STAIN SKIRTING AND ARCHITRAVE DIRTY DOWN SURAFCES	
GIRLS ROOM PINK PAINTED WALLS - DULUX 47RR 32/383 WHITE PAINTED DOOR, SKIRTING AND ARCHITRAVE DULUX 30GY 88/014 DIRTY DOWN SURAFCES	
PLY WALL ENDS AND TOPS OF FLATS TO BE PAINTED BLACK ALL SKIRTING AND DOORS WITH SATIN FINISH	

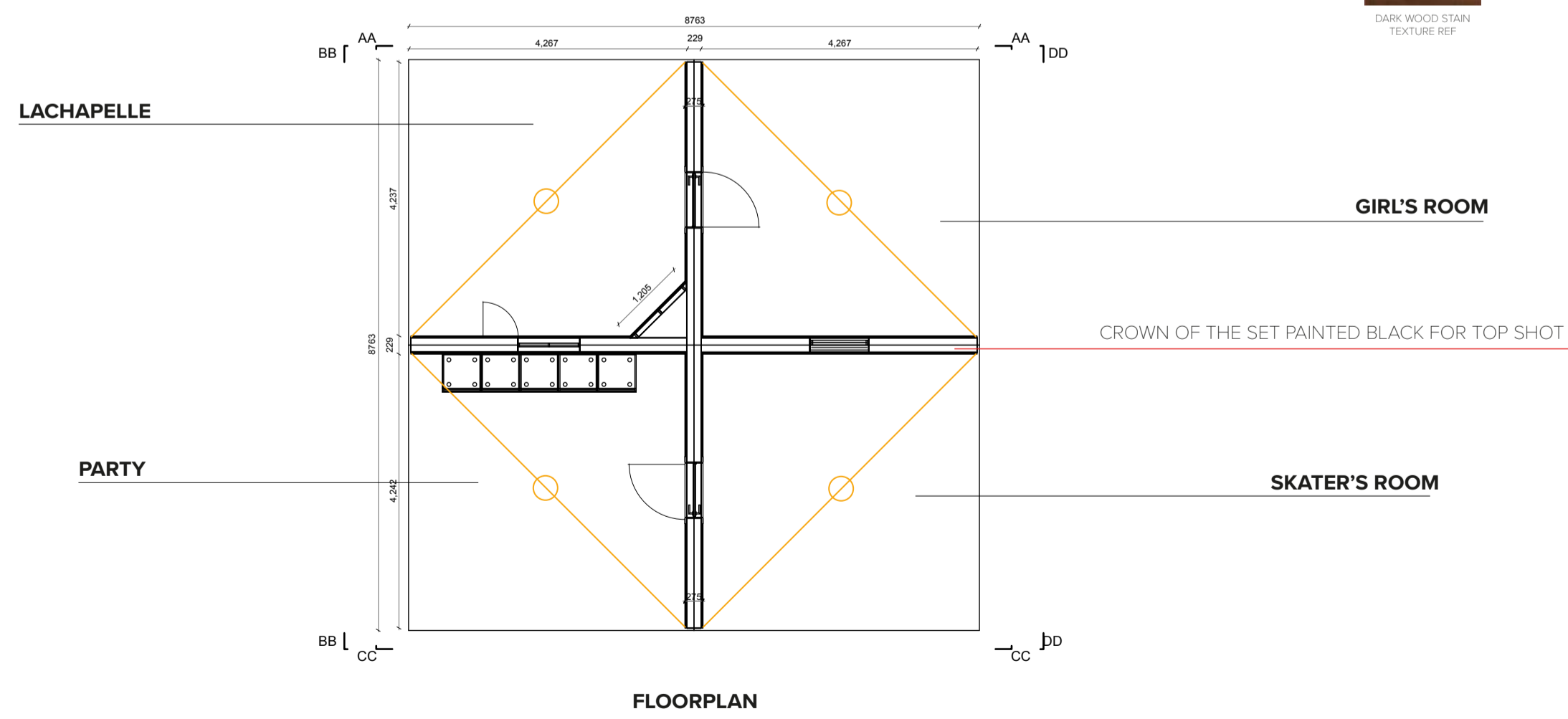

The 1975 - Monday	
SET 4 QUARTER ROOMS	
SHEET 1 OF 1	
DATE	DIRECTOR
06.01.20	
SCALE	PRODUCER
	PRODUCTION DESIGNER
REVISED	BOBBIE COUSINS
10.01.20	DRAWN BY JOSHUA BROOKS mob: 07890499319



THE 1975 - MONDAY // PERFORMANCE SPACE

Floor Plan and Elevations

INSTALLED 15th JANUARY
STRIKE 18th JANUARY

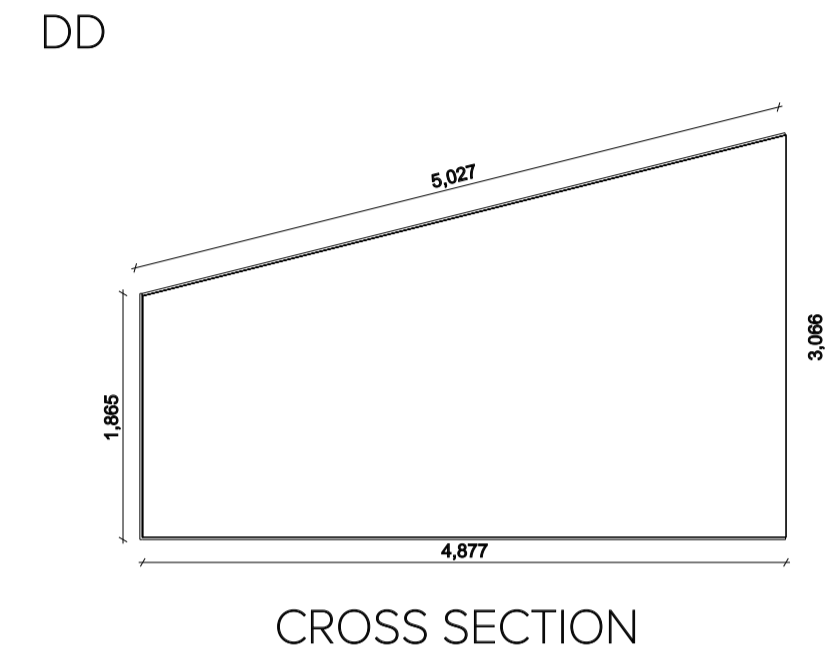
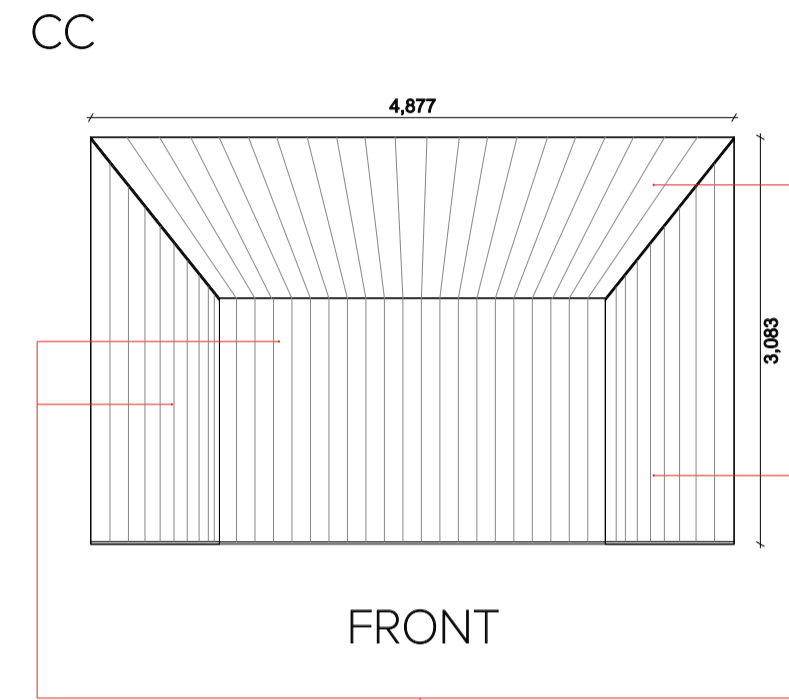
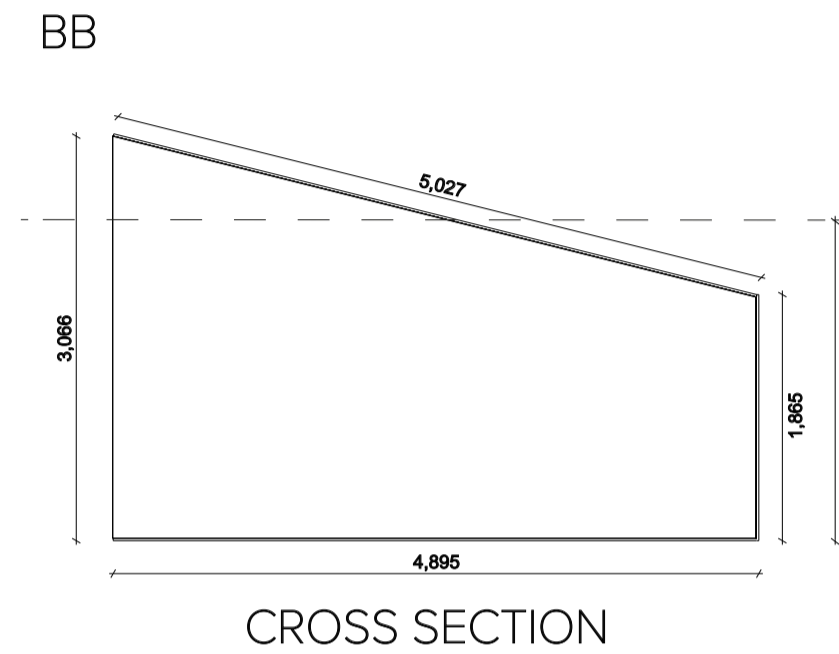
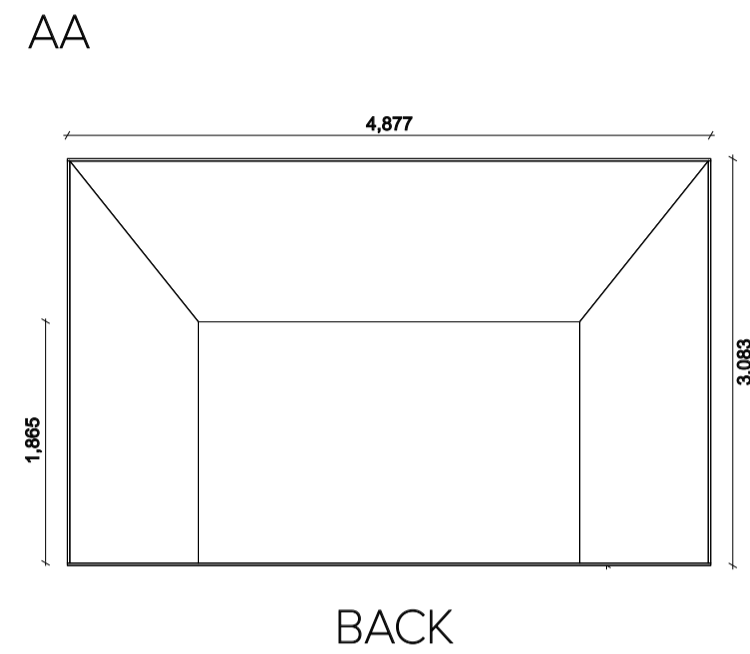

T&G WOOD PANEL TEXTURE



PERFORMANCE SPACE MODEL - FRONT



PERFORMANCE SPACE MODEL - SIDE
WALL AA TO CC INVISIBLE

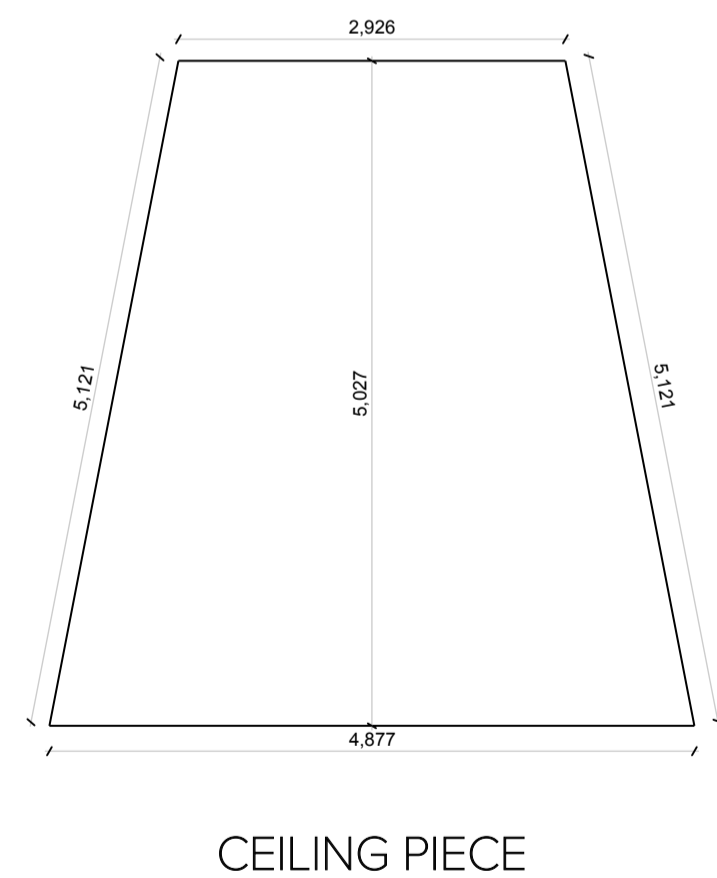
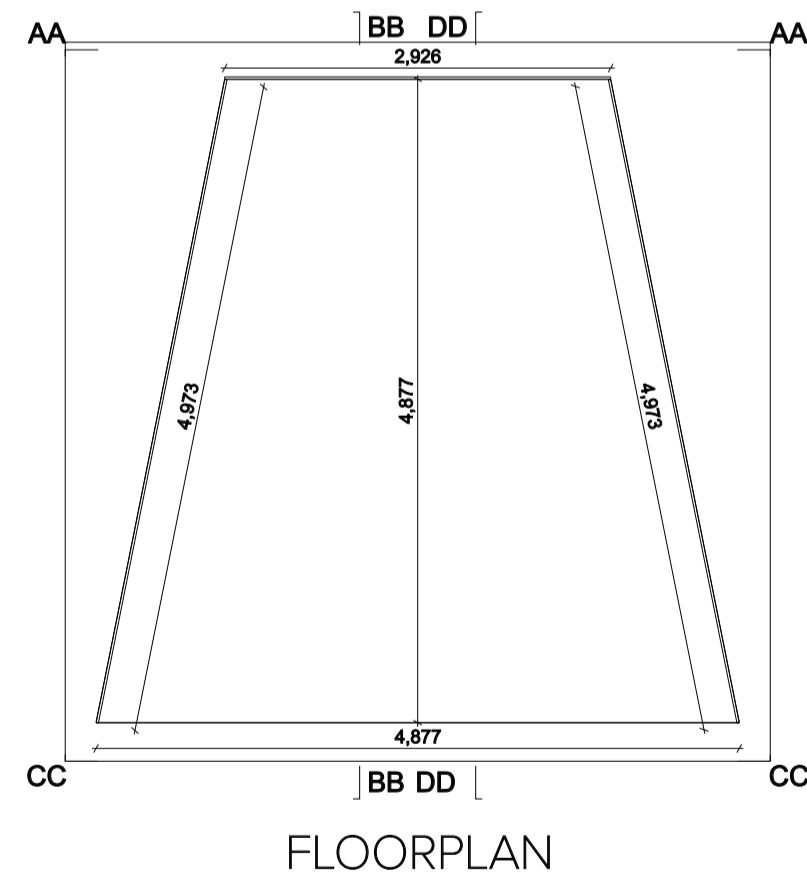





CONSTRUCTION NOTES	
AA	
BB	
CC	MARINE BLUE WOOL CARPET FLOORING T&G WOOD PANEL TEXTURE FOR WALLS AND CEILING DIMENSIONS 8" x H SCALE DOWN 5:3 FRONT FRONT TO BACK
DD	
FLOOR PLAN	CARPET COVERING PERFORMANCE SPACE (TBD) TO BE LAID AFTER CONSTRUCTION WOODEN WALL PANELLING COVERING WALLS OF PERFORMANCE SPACE
PERFORMANCE WILL BE SEEN FROM FRONT VIEW ONLY 6' x 4' PERSPEX SHEET TO HOLD ARTIST	

The 1975 - Monday	
SET	PERFORMANCE SPACE
SHEET 1 OF 1	
DATE	DIRECTOR
07.01.20	
SCALE	PRODUCER
	PRODUCTION DESIGNER
REVISED	DRAWN BY
	JOSHUA BROOKS

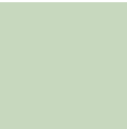

Key

-  Tent
-  Fire
-  Park
-  Paving
-  Tree

Location Photo



NOTES

More tents to the playground's leftside and fewer on the reverse

Disorganised, clutter and litter on the floor

Clothes hung over the goalposts





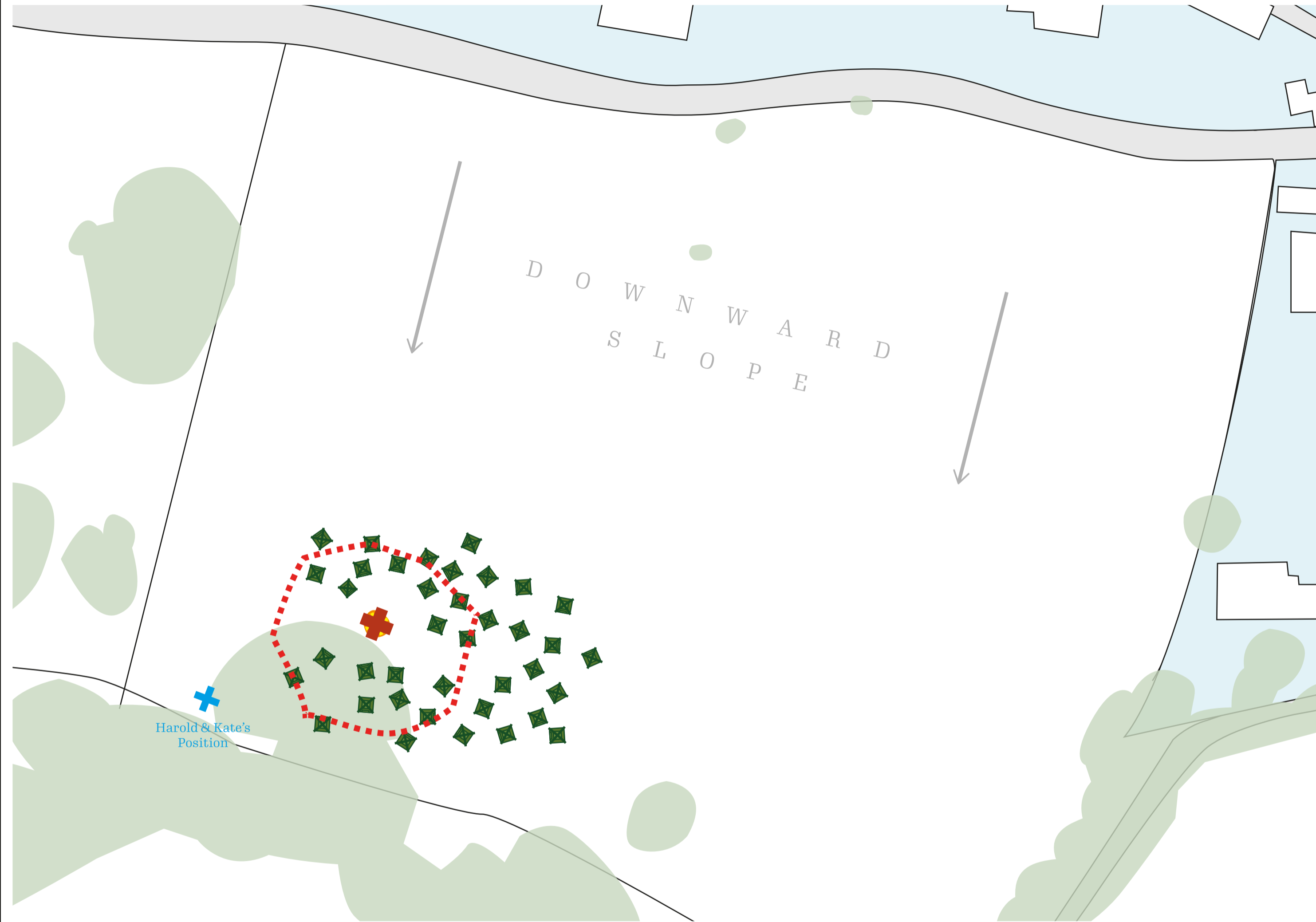

///dock.blend.ready

0m 5m 10m 20m

The Unlikely Pilgrimage of Harold Fry // Campsite 4 Site Plans // Pearson Lane/ Botany Lane Dewsbury area // NOT TO SCALE

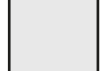

Key

-  Tent
-  Fire
-  Festoon Lighting
-  Trees
-  Residential Area
-  Road
-  Tree

Location photos



NOTES

Further down the hill crowded into the bottom left corner of the field.

Should fill the flat area at the bottom of the slop

Large 5' diameter fire

///knowledge.battle.saloons

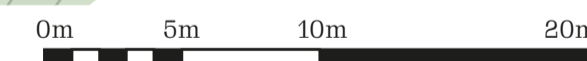

Director: Hettie Macdonald Production Designer: Christina Moore Art Director: Iain White

Drawing by Joshua Brooks
Email: joshuajabrooks@gmail.com
Mob: 07890499931

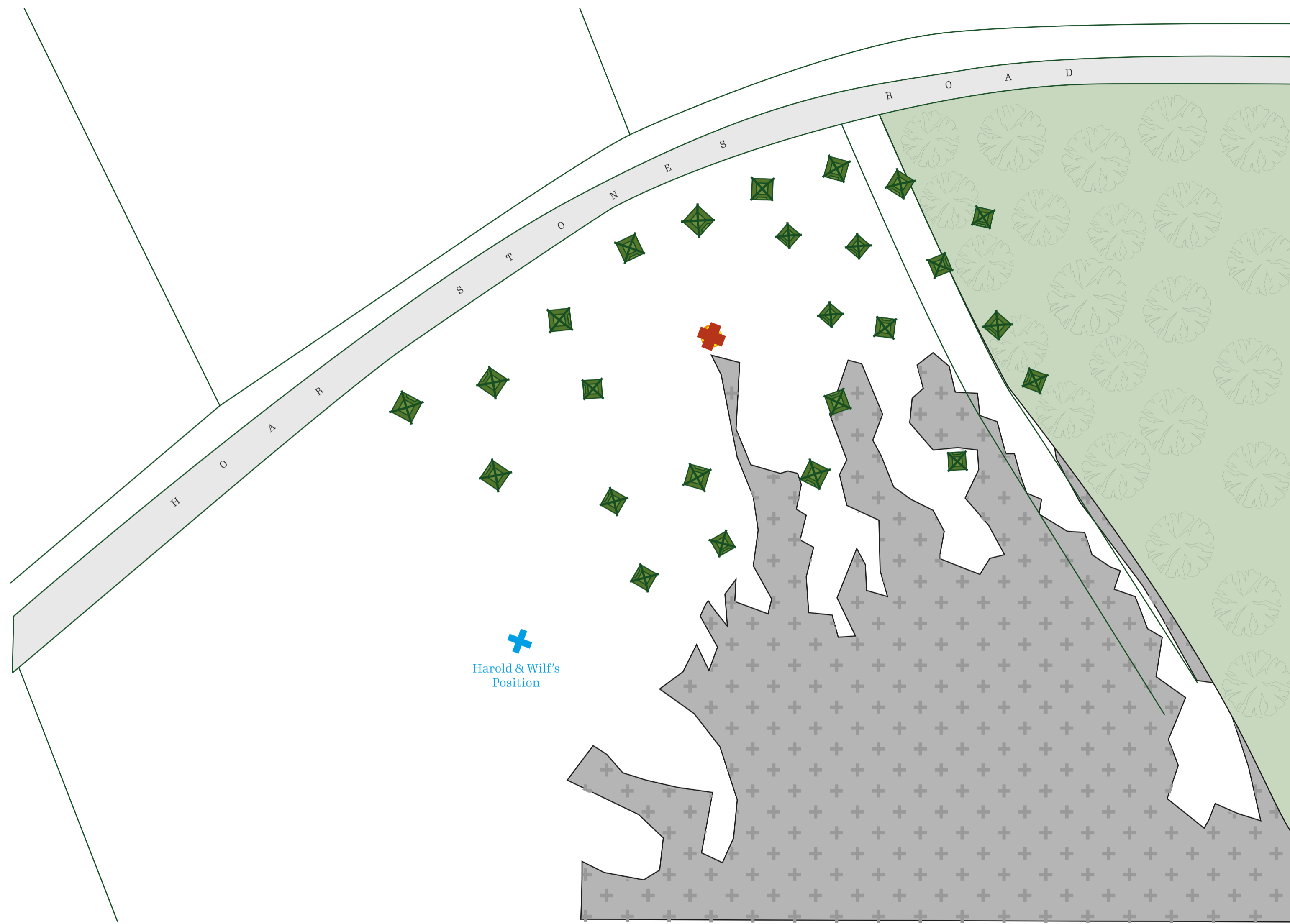

Key

- Harold's Tent
- Tent
- Fire
- Tree
- Rock

Location Photo



NOTES

Tents to spread widely around fire

The camp fire is very key here, and needs an area for 50/60 people to sit all around it and space for some to be dancing so probably needs more space around it..with the tents falling away in all directions from that.

///firm.lamp.loads



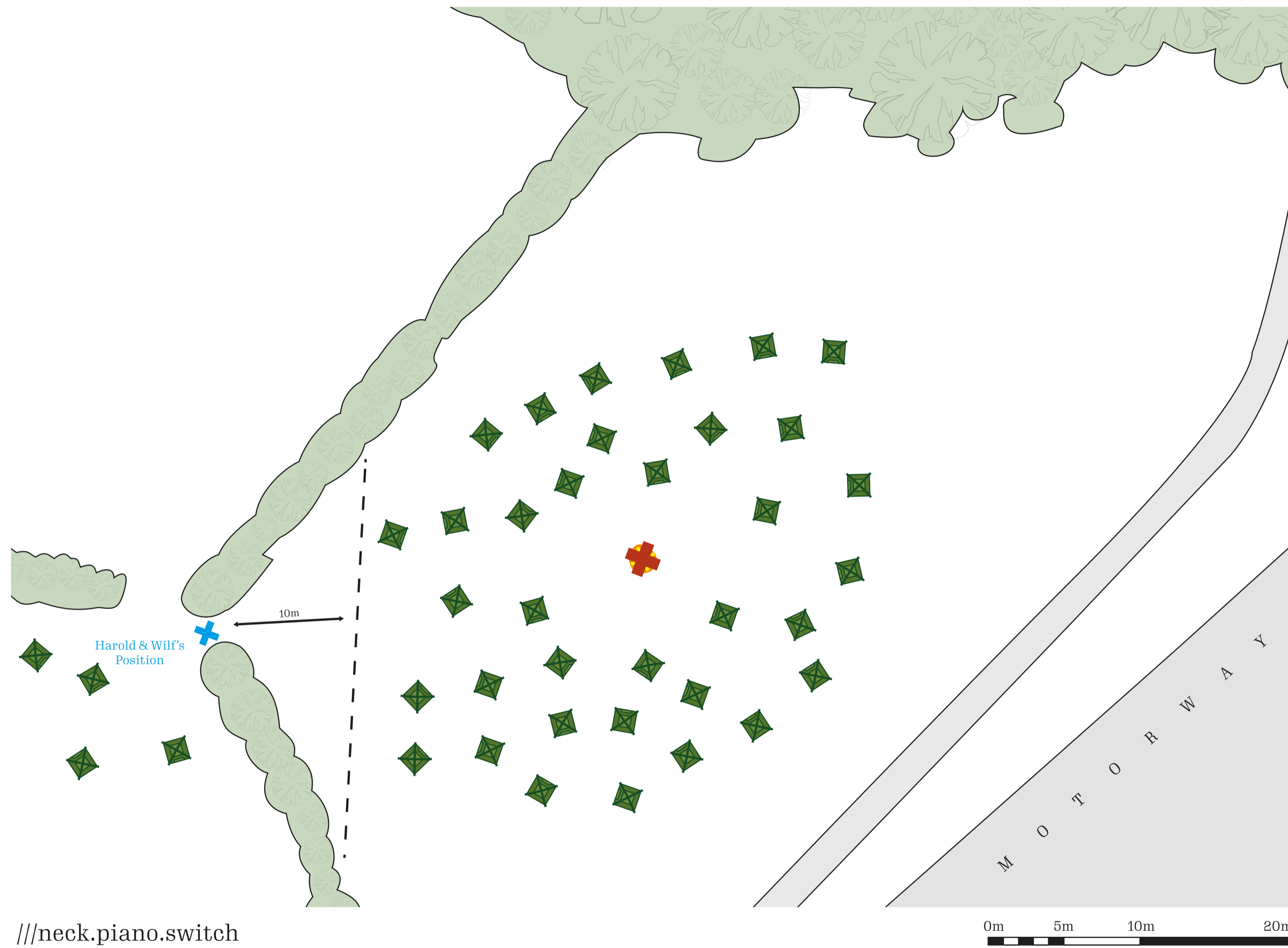

Director: Hettie Macdonald Production Designer: Christina Moore Art Director: Iain White

Drawing by Joshua Brooks
 Email: joshuajabrooks@gmail.com
 Mob: 07890499931

The Unlikely Pilgrimage of Harold Fry // Campsite 3 Site Plans // Lingwell Gate Lane, Wakefield // NOT TO SCALE



Key

-  Tent
-  Fire
-  Trees
-  Tree
-  Road



NOTES

Room between the tents for Harold and the camera (Kate with all her gimble crew) to thread their way through the tents here

There are others who are sleeping on ground sheets etc as well. Just so H and Wilf are not the only ones (we should see this throughout)

3/4 tents in the neighbouring field for reverse of H and Wilf

Director: Hettie Macdonald Production Designer: Christina Moore Art Director: Iain White

Drawing by Joshua Brooks
 Email: joshuajabrooks@gmail.com
 Mob: 07890499931



JOSHUA BROOKS

THE UNLIKELY PILGRIMAGE OF HAROLD FRY - RECCE PHOTO











EXTERIOR

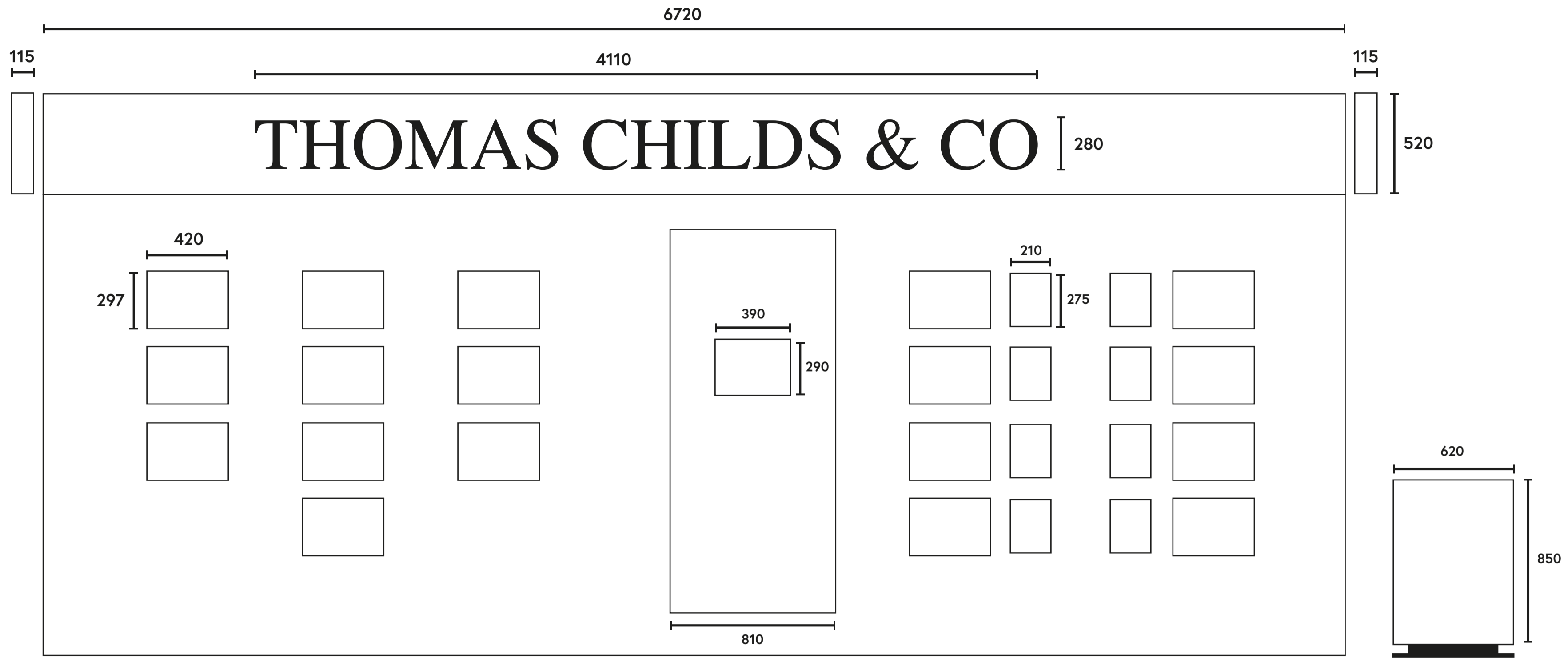

INTERIOR

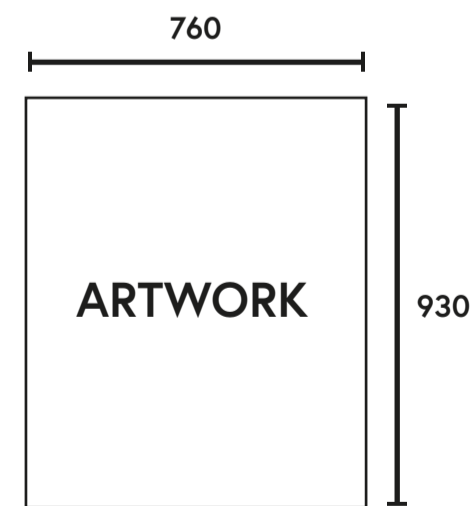
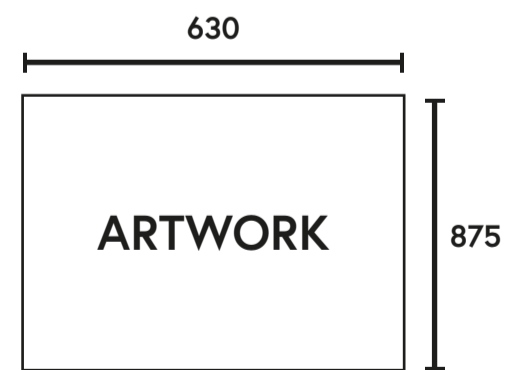
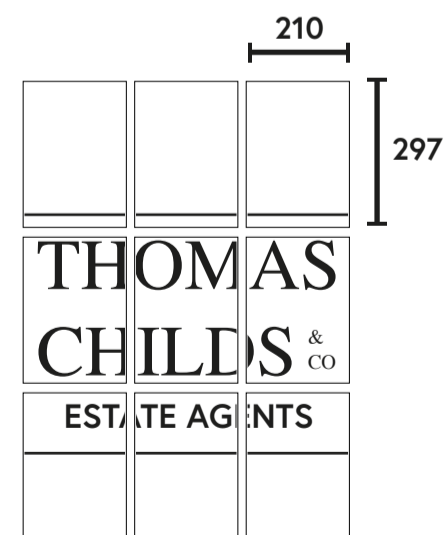

PROPS

- Office Chair
- Pram
- Tungsten Anglepoise lamp

- Artwork (framed)
- Cleared Magazines
- Plants
- Fairy lights
- Business cards
- Flyers
- Certificates



BEFORE



BEFORE



AQUA
PARFUM
SHOWER GEL

Aqua Parfum multi-rose flower reveals a sensual shower experience. Our skin-lining formulation with an enlightening orange fragrance, cleans and hydrates, so your skin can enjoy its natural softness.

Not all flowers are the same... Aqua Parfum shows, some are perfectly for all the family & the aromas that will give you a perfect bath.

We want to help to make your routine and your skin healthy, that's why we've created our Aqua Parfum skin care line. It's the perfect choice for your skin care routine. Aqua Parfum is available in the UK. By May 2015, there will be over 100 different Aqua Parfum products to choose from. We'll be back in the UK by 2015.

© 2015 Princes Court, London, SE16 7TD

Aqua Parfum multi-rose flower reveals a sensual shower experience. Our skin-lining formulation with an enlightening orange fragrance, cleans and hydrates, so your skin can enjoy its natural softness.

All natural ingredients. No synthetic fragrances. No parabens. No phthalates. No sulfates. No formaldehyde. No mineral oil. No silicones. No alcohol. No GMO. No cruelty. No animal testing. No synthetic colors. No synthetic perfumes. No synthetic preservatives. No synthetic stabilizers. No synthetic emulsifiers. No synthetic solvents. No synthetic surfactants. No synthetic detergents. No synthetic cleaning agents. No synthetic disinfectants. No synthetic sanitizers. No synthetic antiseptics. No synthetic antibiotics. No synthetic antifungals. No synthetic antivirals. No synthetic antiparasitics. No synthetic antitumorals. No synthetic anticancer agents. No synthetic immunosuppressants. No synthetic immunomodulators. No synthetic immunostimulants. No synthetic immunosuppressants. No synthetic immunomodulators. No synthetic immunostimulants.



500ml e

AQUA
PARFUM
LAVENDER
670
Lavender flowers help craft this shower gel

500ml e

DERMATOLOGICAL SKIN HYDRATION

Active eczema cream
No.1 GP Recommended*

Best for dry, eczema-prone skin

A soothing and moisturising daily cream that softens and protects.

Fragrance free with natural oils

475ml e

Directions for using the pump: Prime the pump before first use by pressing fully until cream appears. If the pump stops working do not dismantle the pack. Re-use by covering the nozzle then fully depress the pump several times to expel air.

Adults, the elderly and children over 1 year: Wash and dry hands before use. Apply to dry skin areas as often as required and smooth gently into the skin following the direction of hair growth. Children under 1 year should be treated under medical supervision.

Hazards and Cautions: Not for use on open wounds. Do not use on the face, neck, hands, or feet. Avoid contact with eyes.

Precautions: Mild skin reactions, such as redness and rash, have been seen rarely. Should this occur, use of the product should be stopped. In the unlikely event of side-effects, you should talk to your doctor or pharmacist. Do not use if you are allergic to any of the ingredients listed. Talk to your doctor before use if the skin is badly cracked, infected or bleeding. Avoid contact with the eyes. If you accidentally swallow the product, seek medical advice and take your child to see their GP.

Contains: purified water, white soft paraffin 13.2%, white liquid paraffin 10.5%, emulsifying wax (SLS free), polyacrylate 50, glycerol (vegetable), alcohol, phenylethyl alcohol, sodium citrate, citric acid monohydrate.

Keep out of the reach and sight of children. Do not store above 25°C. Use within 3 months of opening. Do not use after expiry date. Dispose of packaging in line with local requirements.

Ingredients: Some important information about the ingredients: This product contains necessary alcohol which may cause local skin reactions.

Contains: purified water, white soft paraffin 13.2%, white liquid paraffin 10.5%, emulsifying wax (SLS free), polyacrylate 50, glycerol (vegetable), alcohol, phenylethyl alcohol, sodium citrate, citric acid monohydrate.

Princes Inc Ltd
30 Princes Court, London, SE16 7TD

CE

475ml e

USES

Surface Disinfection - Skin Sterilisation - Kills 99.9% of Germs & Bacteria

ACTIVE INGREDIENT - Ethyl Alcohol 75%
Purpose - Antiseptic disinfecting antibacterial purposes
Inactive Ingredients / Water, Glycerin, Parfum

Directions:

Antibacterial Surface Disinfection -
Rub wipe over surface and clean affected areas, wipe can be used on both sides. Discard wipe after use.

Antiseptic Hand Hygiene -
Adults and children over 2 years: Rub wipe over hands and in-between fingers for at least 20 seconds. Allow to dry. Children may use this product under adult supervision. Do not use on children less than 2 years of age unless directed by a doctor, health care practitioner of health care professional.

CAUTION:
Flammable - Keep away from heat, sources of ignition and open flames. Keep out of reach of children. Do not use on children less than 2 years old unless directed by a doctor or health care practitioner. If swallowed, contact emergency services and seek medical attention. If irritation occurs stop use and consult your doctor. External use only.

Manufactured by: BROOK PHARMA LTD
30 Princes Court, London, SE16 7TD
www.brookpharma.co.uk
e-mail: info@brookpharma.co.uk

ALCOHOLIC
SANITISING
WIPES

200 READY TO USE WIPES
Rapidly eliminate bacteria on hard surfaces

Kills 99.9% of bacteria

TESTED TO - EN1276, EN13704, EN1650, EN13697

NEW

ARGAN OIL
BODY
HYDRATING LOTION

Enriched with an exquisite blend of incredible treasures from the beehive. Beeswax - a natural shield of the hive, known for creating a protective barrier. Argan - a nourishing and soothing oil. This creates a rich creamy texture, with camellia scents, that leaves your skin feeling intensely nourished. It is fast absorbing so that you can get dressed immediately as well as being non-sticky and non-greasy.

LOCKS IN MOISTURE LEAVING SKIN FEELING SOFTER

Our Body Lotion leaves your skin feeling intensely nourished and instantly soothed. Made for very dry skin, the formula leaves skin feeling softer and more supple day after day.

Warnings or Restrictions
Do not apply on face, avoid contact with eyes.

Product Specification
967130 11 - INGREDIENTS: AQUA / WATER, GLYCERIN, ISOPROPYL PALMITATE, PARAFFINUM LIQUIDUM / MINERAL OIL, DIMETHICONE, CETEARYL ALCOHOL, GLYCERYL STEARATE, BUTYROSPERMUM PARKII BUTTER / SHEA BUTTER, CETYL ESTERS, MEL / HONEY, PEG-100 STEARATE, CERA ALBA / BEESWAX, SODIUM POLYACRYLATE, CAPRYLYL GLYCOL, CITRIC ACID, PENTAERYTHRITYL TETRA-DI-T-BUTYL HYDROXYHYDROXYCINNAMATE, PHENOXYETHANOL, BENZOIC ACID, CI 15110 / ORANGE 4, CI 19140 / YELLOW 5, COUMARIN, LIMONENE, BENZYL ALCOHOL, BENZYL SALICYLATE, PARFUM / FRAGRANCE (F.I.L. B256090/1).

Princes Inc Ltd
30 Princes Court, SE16 7TD
020 4329 9332

ALL NATURAL INGREDIENTS
ORIGINAL
NON GREASY, SMOOTH

250ML e

NEW

ARGAN OIL

ARGAN & CAMELLIA OILS: MOISTURISE AND HYDRATE

Enriched with an exquisite blend of incredible treasures from the beehive. Beeswax - a natural shield of the hive, known for creating a protective barrier. Argan - a nourishing and soothing oil. This creates a rich creamy texture, with camellia scents, that leaves your skin feeling intensely nourished. It is fast absorbing so that you can get dressed immediately as well as being non-sticky and non-greasy.

LOCKS IN MOISTURE LEAVING SKIN FEELING SOFTER

Our Body Lotion leaves your skin feeling intensely nourished and instantly soothed. Made for very dry skin, the formula leaves skin feeling softer and more supple day after day.

Warnings or Restrictions
Do not apply on face, avoid contact with eyes.

Product Specification
967130 11 - INGREDIENTS: AQUA / WATER, GLYCERIN, ISOPROPYL PALMITATE, PARAFFINUM LIQUIDUM / MINERAL OIL, DIMETHICONE, CETEARYL ALCOHOL, GLYCERYL STEARATE, BUTYROSPERMUM PARKII BUTTER / SHEA BUTTER, CETYL ESTERS, MEL / HONEY, PEG-100 STEARATE, CERA ALBA / BEESWAX, SODIUM POLYACRYLATE, CAPRYLYL GLYCOL, CITRIC ACID, PENTAERYTHRITYL TETRA-DI-T-BUTYL HYDROXYHYDROXYCINNAMATE, PHENOXYETHANOL, BENZOIC ACID, CI 15110 / ORANGE 4, CI 19140 / YELLOW 5, COUMARIN, LIMONENE, BENZYL ALCOHOL, BENZYL SALICYLATE, PARFUM / FRAGRANCE (F.I.L. B256090/1).

Princes Inc Ltd
30 Princes Court, SE16 7TD
020 4329 9332

ALL NATURAL INGREDIENTS
ORIGINAL
NON GREASY, SMOOTH

250ML e

USING SKITTY'S FAMILY OWNED RECIPE

Skitty's
SYRUP

HIGHEST QUALITY SYRUP SINCE 1863

Original

INGREDIENTS: PURE MAPLE SYRUP.

Distributed by Princes Incorporated, 30 Princes Court, London, SE16 7TD
PRODUCT OF THE UNITED KINGDOM

Keep refrigerated once opened

Princes Inc Ltd
30 Princes Court, SE16 7TD
020 4329 9332

Nutrition Facts

Per 1 cup (150g)	
Serving Size	
Calories 245 735	
Total Fat	15g (30%)
Total Sugar	15g (30%)
Total Protein	15g (30%)

Suitable for Vegans

USING SKITTY'S FAMILY OWNED RECIPE

Skitty's
SYRUP

HIGHEST QUALITY SYRUP SINCE 1863

Original

INGREDIENTS: PURE MAPLE SYRUP.

Distributed by Princes Incorporated, 30 Princes Court, London, SE16 7TD
PRODUCT OF THE UNITED KINGDOM

Keep refrigerated once opened

Princes Inc Ltd
30 Princes Court, SE16 7TD
020 4329 9332

Nutrition Facts

Per 1 cup (150g)	
Serving Size	
Calories 245 735	
Total Fat	15g (30%)
Total Sugar	15g (30%)
Total Protein	15g (30%)

Suitable for Vegans

⚠ DANGER

OXYGEN, COMPRESSED USP
UN1072

10 Litre O2 Oxygen Can secured in 1.8 Metre Tubing

O2 99.5% Pure Oxygen Can

O2 Pure Oxygen improves wellbeing, giving energy and drive. It's energising and adds vitality, improving concentration. It helps you to feel better equipped to get through a stressful day.

O2 Oxygen cans are filled with 99.5% pure oxygen and 0-10 breaths are sufficient to feel noticeably better, quickly.

WARNING:
EXTREMELY COLD DANGEROUS LIQUID AND GAS UNDER PRESSURE.
VIGOROUSLY ACCELERATES COMBUSTION. COMBUSTIBLES IN CONTACT WITH LIQUID OXYGEN MAY EXPLODE ON IGNITION OR IMPACT. CAN CAUSE SEVERE FROSTBITE.
Keep out of grease and combustible areas. Use only with equipment cleaned for oxygen service.
Store and use with adequate ventilation. Do not get liquid in eyes, on skin or clothing. For liquid withdrawal, wear face shield and gloves. Do not drop. Use suitable hand truck for container movement.
Avoid spills. Do not walk on or roll equipment over 300 lbs. Cylinder temperature should not exceed 125°F (50°C). Close valve after each use and when empty. Use in accordance with the Material Safety Data Sheet (MSDS).

IN CASE OF FROSTBITE, obtain medical treatment immediately.

↑ ALWAYS KEEP CONTAINER IN UPRIGHT POSITION. ↓
SECURE ALL CYLINDERS WHILE IN STORAGE AND IN USE.



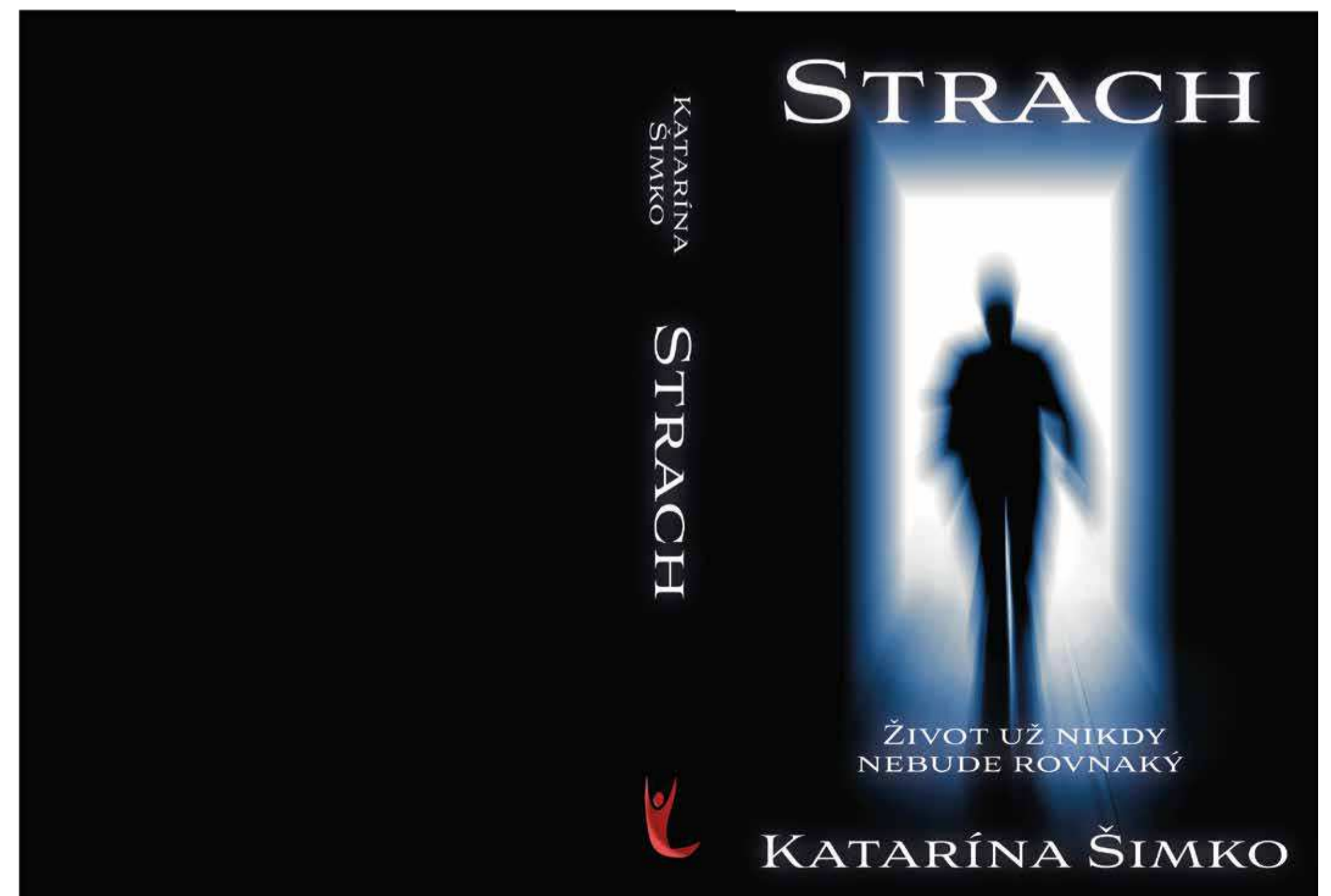
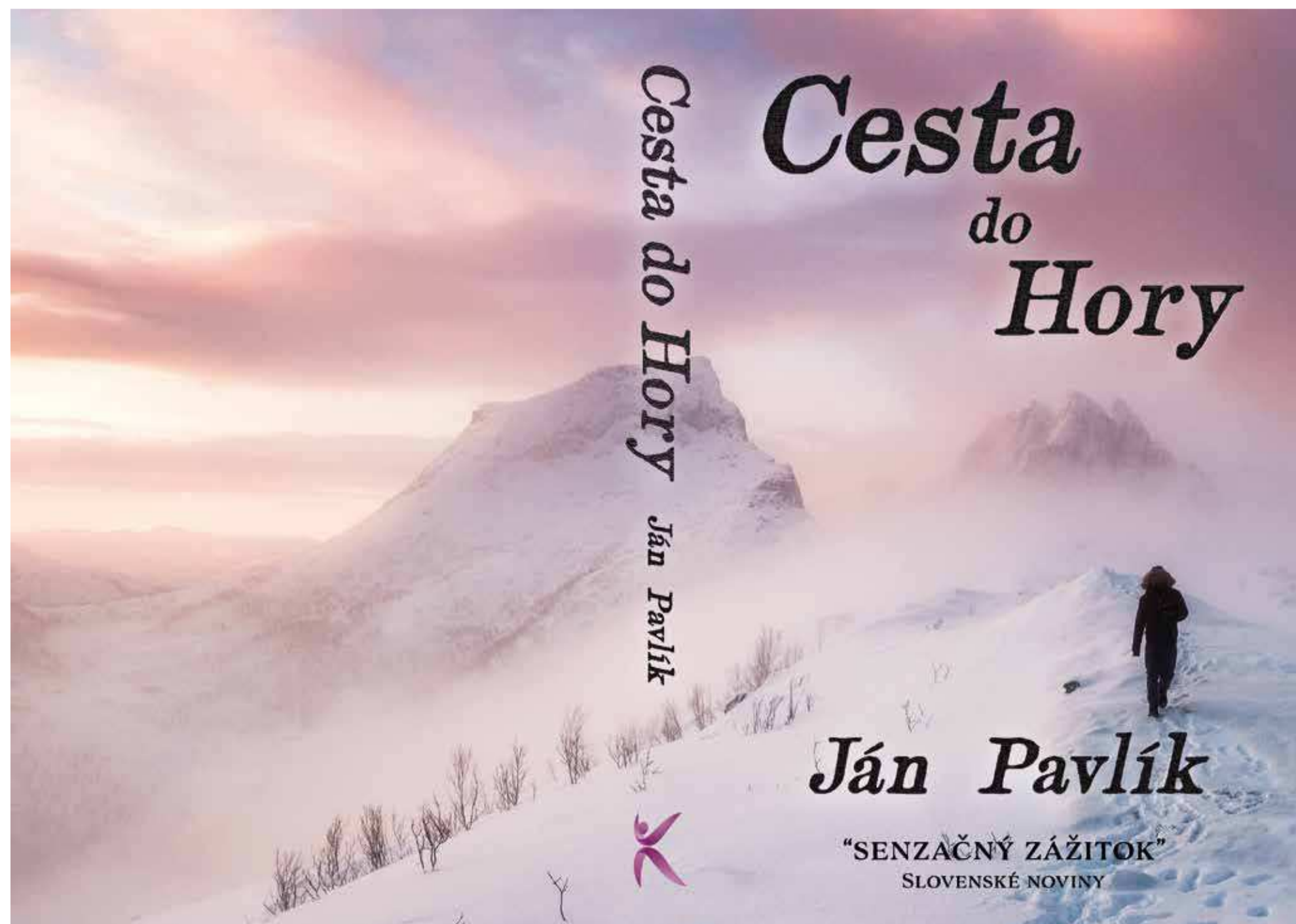
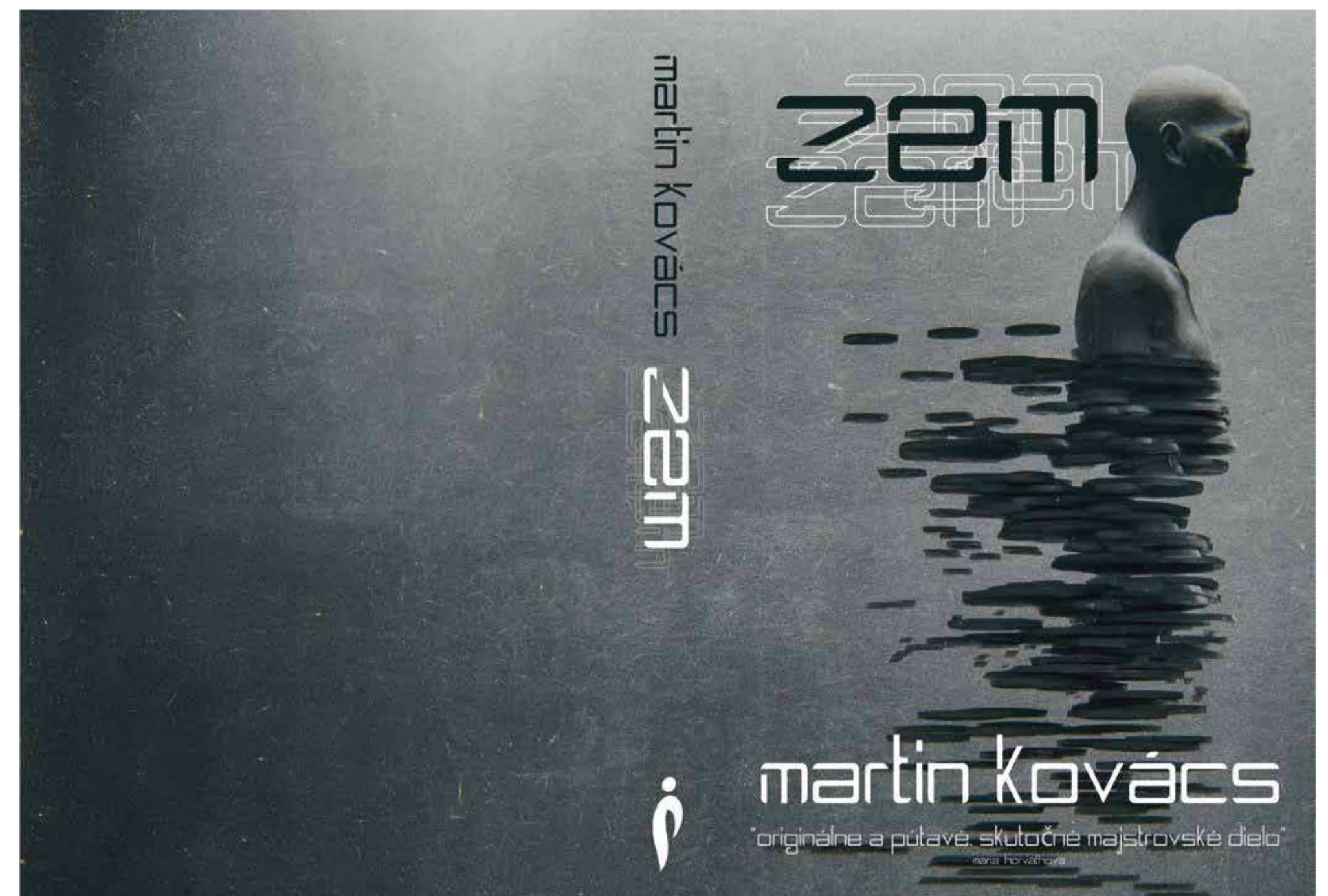
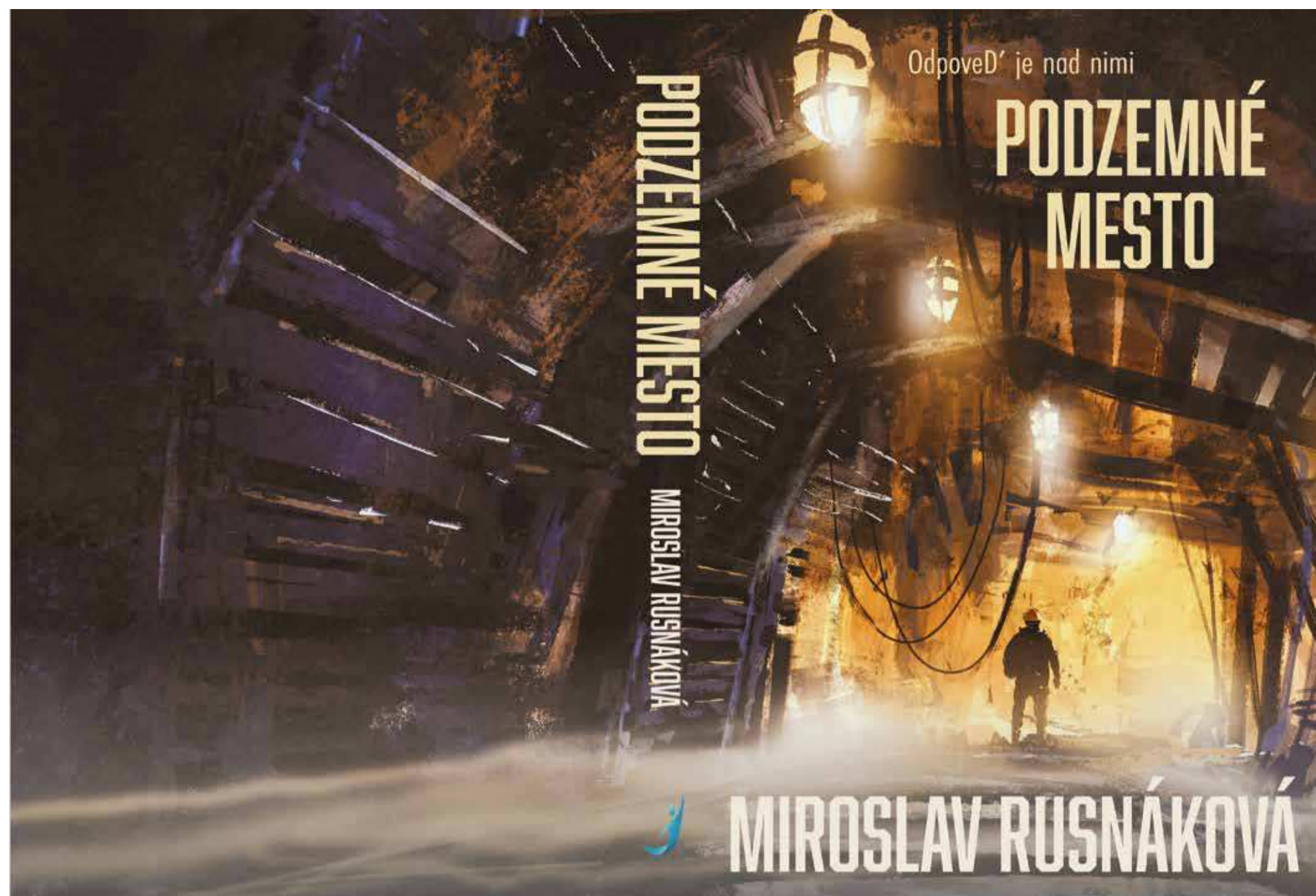

SKATE
SKATE
SKATE
SKATE
SKATE



Get some real air time.

GOLDEN
BY
NATURE.

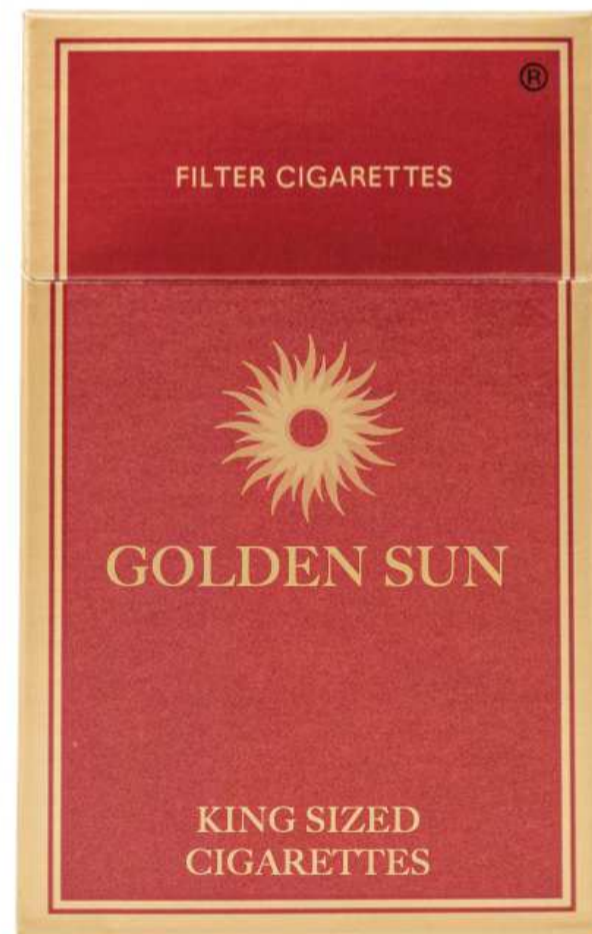

Sungrown tobacco, full of flavour.

AVAILABLE IN KINGS AND KINGS LIGHTS

Retail price may vary

SURGEONS GENERAL WARNING: Smoking By
Pregnant Women May Result in Fatal Injury,
Premature Birth and Low Birth Weight.

Kings lights 10mg tar 0.7mg nicotine - Kings 14mg
tar 1.0mg nicotine as per cigarette by method

Stay looking glamorous.

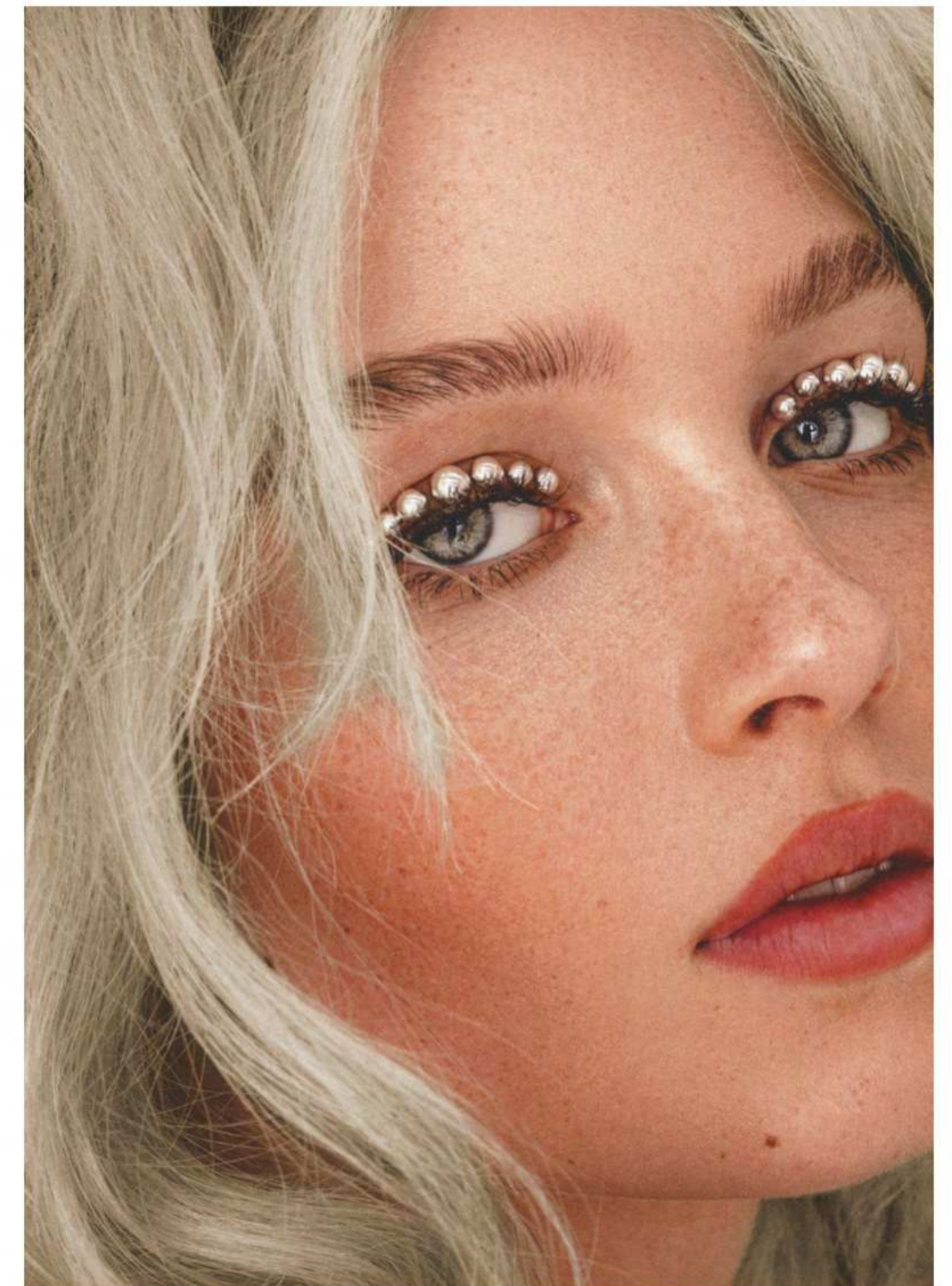

The long lasting mascara that makes us first choice for beauty.

Charlotte.
Beauty & Style

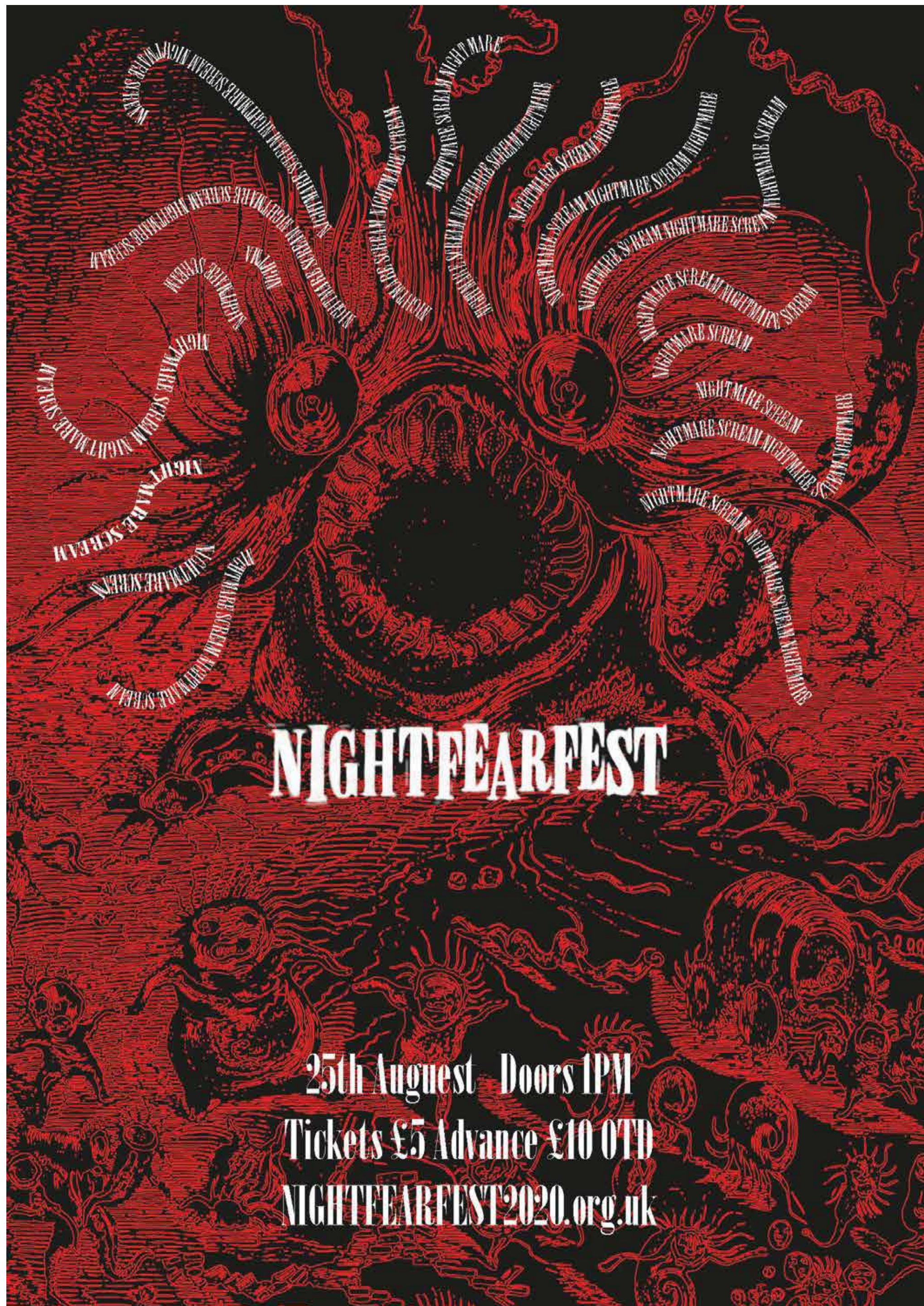

JOSHUA BROOKS

LADYPARTS - GIG POSTER GRAPCHIS

SKUHL CRACH PRESENTS

IN PARTNERSHIP WITH

STAGELOCO

DEAF OWLS

FOURDUST

Velvet Ash

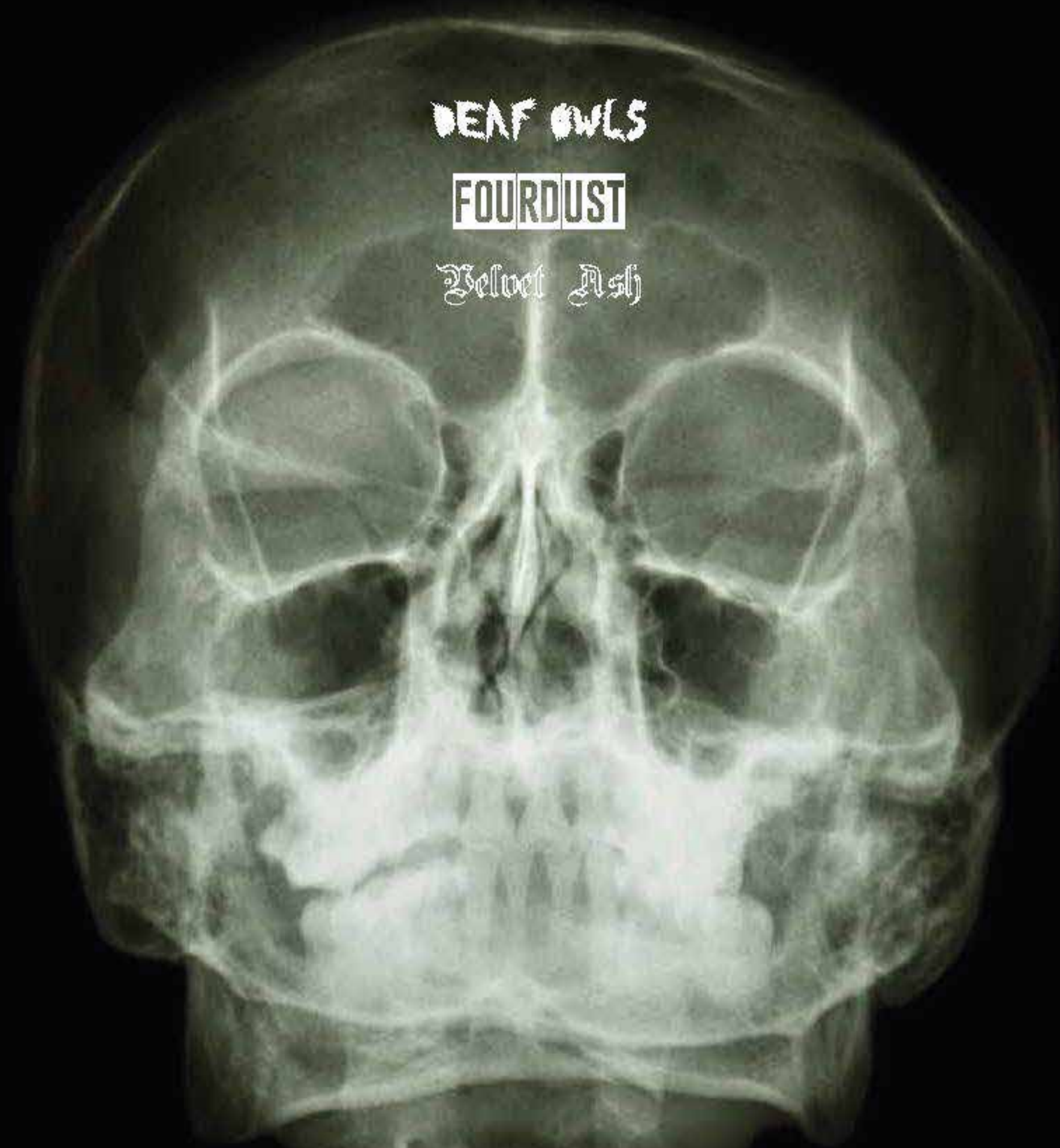

MMXX

19:00 - 23:00

THE DOWNSTAIR BAR

£7 Advance / £10 OTD

BURN IT

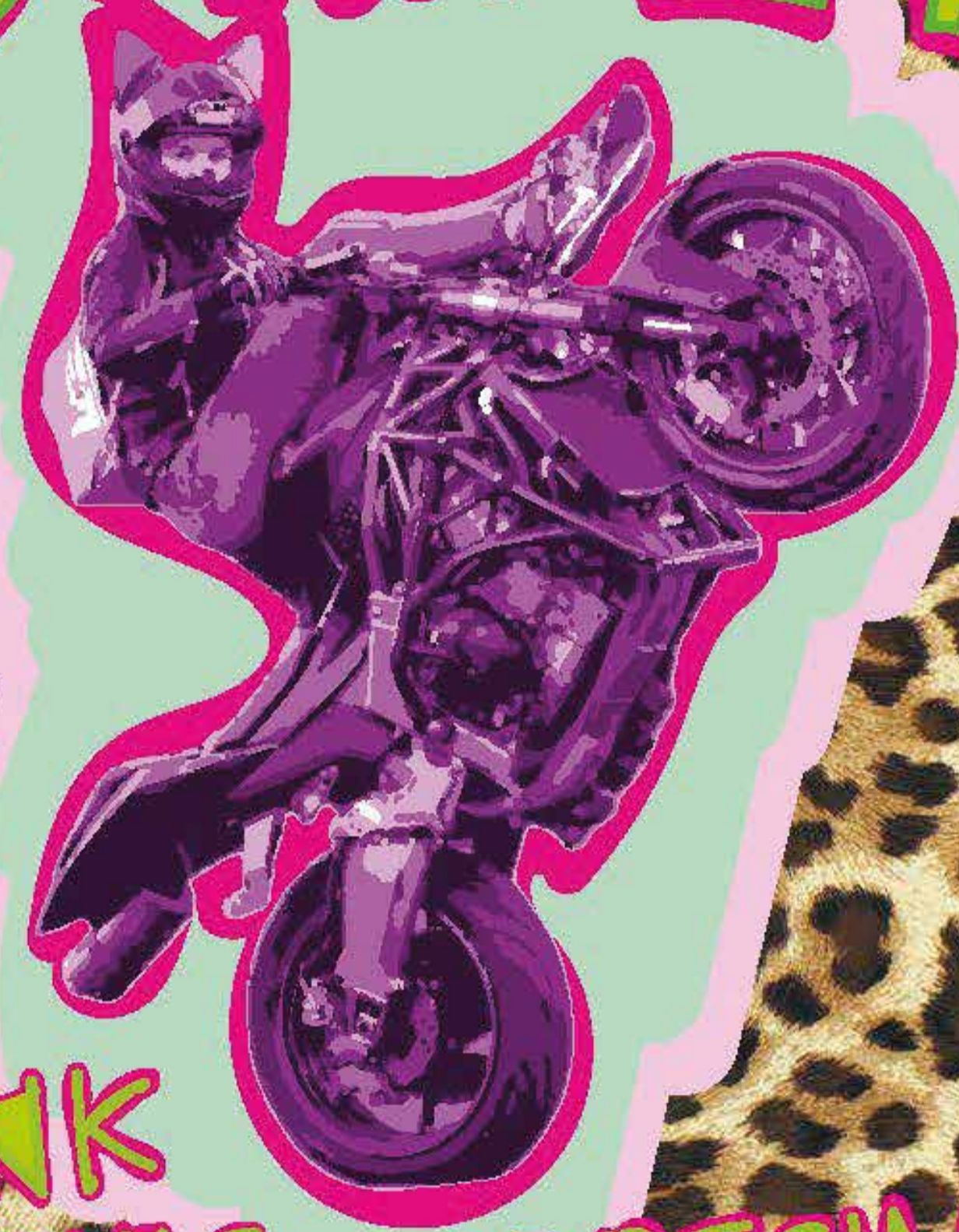

PINK
PINS + SPECIAL
QUEST

